

**ALL-IN-ONE
SOLAR LED STREET LIGHT**



OVERVIEW



ELECTRICAL SOLAR PANEL CHARGING

With 23% high efficiency conversion rate,
Which can also be charged in low light environment,
Smart charging during the day smart lights at night.

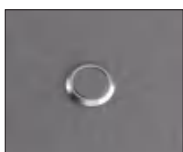

Switch Button



Optional Sensor



Lithium Battery



Solar energy



Long battery life



Intelligent control

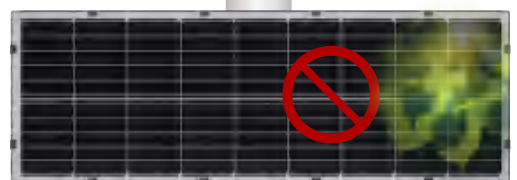
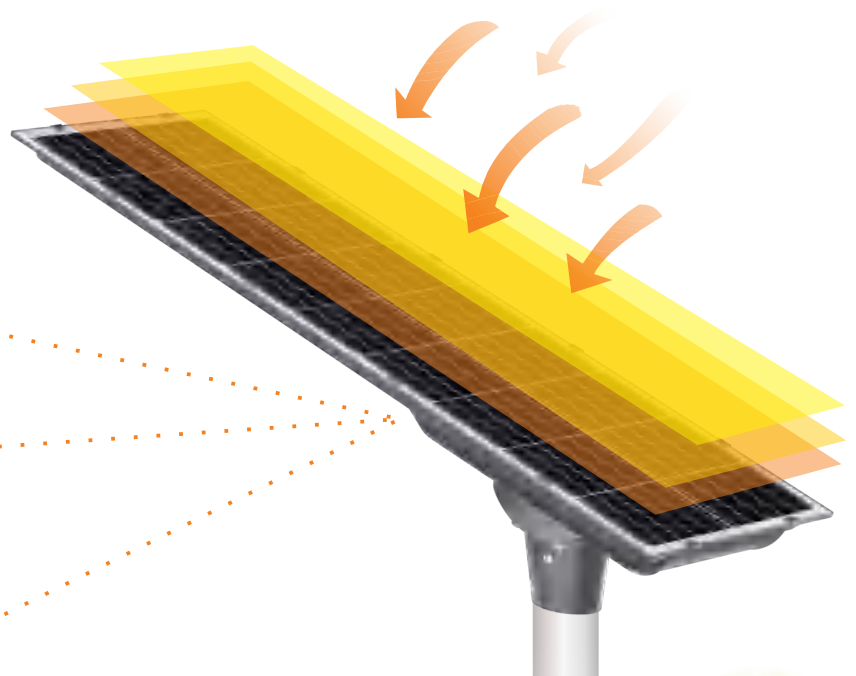

Solar panel should be installed towards sunshine.
And could NOT be covered by trees or buildings.

EXPLODED

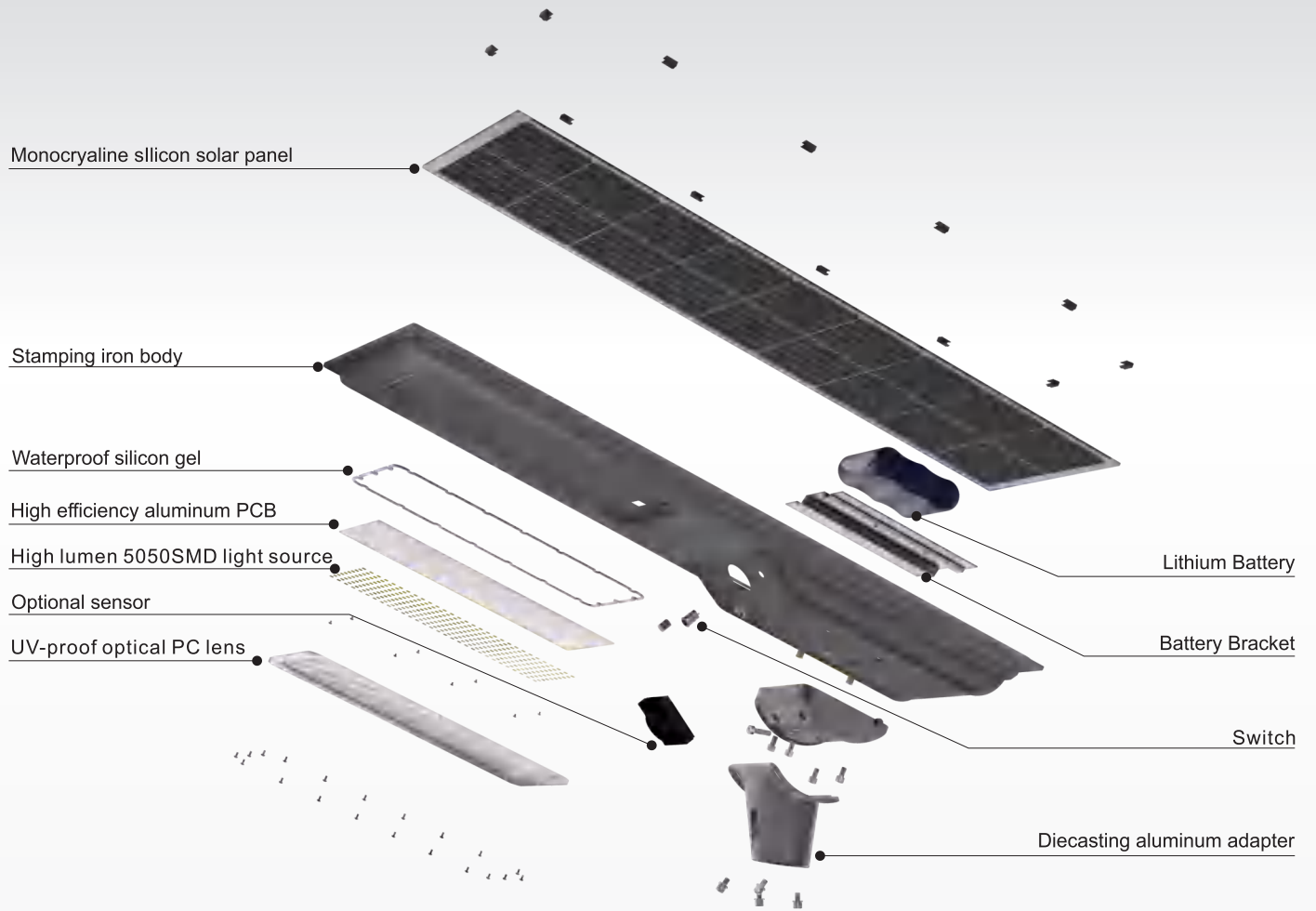

Adjustable /Non-adjustable Adapter.



Horizontal Installation

Vertical Installation

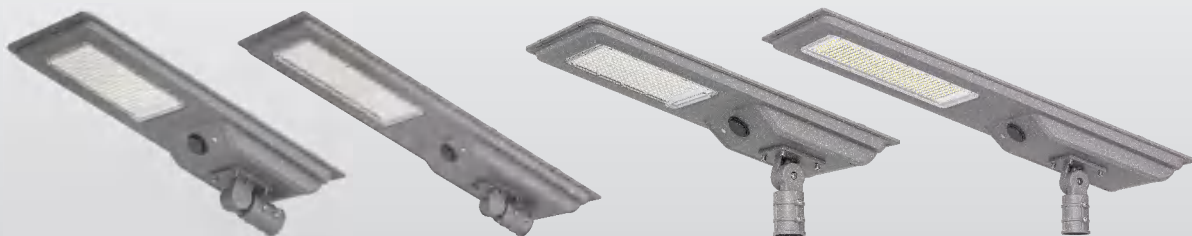

APPLICATIONS

Suitable for road lighting in urban areas such as urban streets and main traffic roads.



INSTALLATION METHODS



OPTICS

Tech. Support: Please provide the information of road length, width, height and application scene to us. Our professional engineer team will proceed the lighting DIALUS simulation and evaluate the lighting quantity and effect for your project. ies files are available upon request.

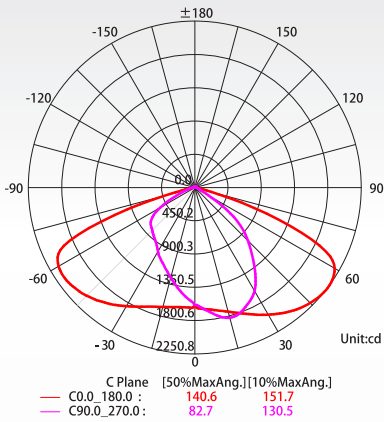

C plane lighting distributions
75°140°

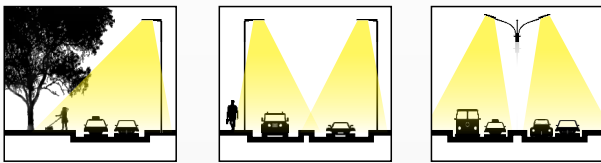
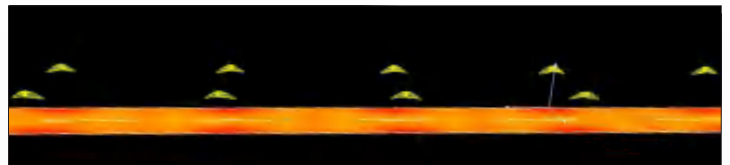
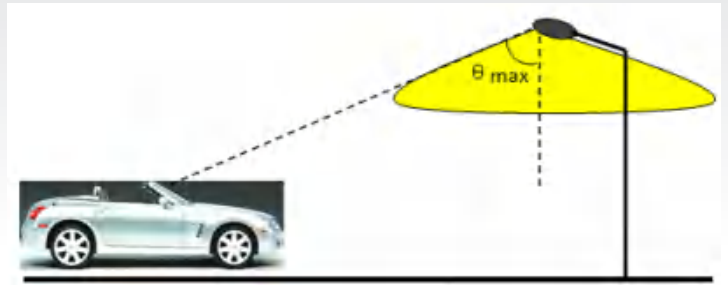

Light control switch: lights off at dawn, lights on at night

Time control mode: Set a fixed on/off time, for example, automatically turn on the street light at 18:00 every night and automatically turn off the street light at 6:00 the next morning.

Full brightness 100% when people come
/light brightness 10% when people leave

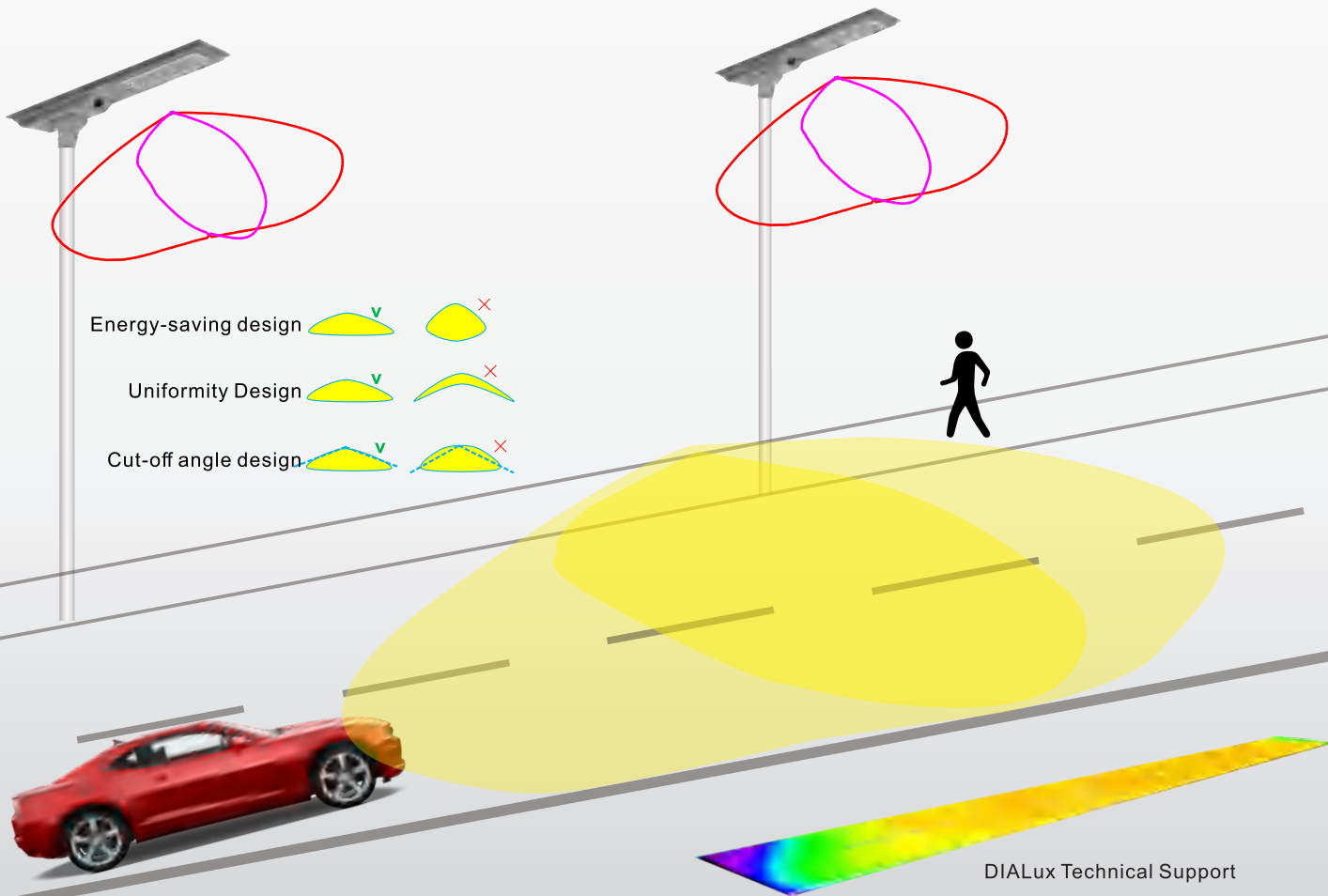

- Energy-saving design
- Uniformity Design
- Cut-off angle design

ADJUSTABLE MODEL

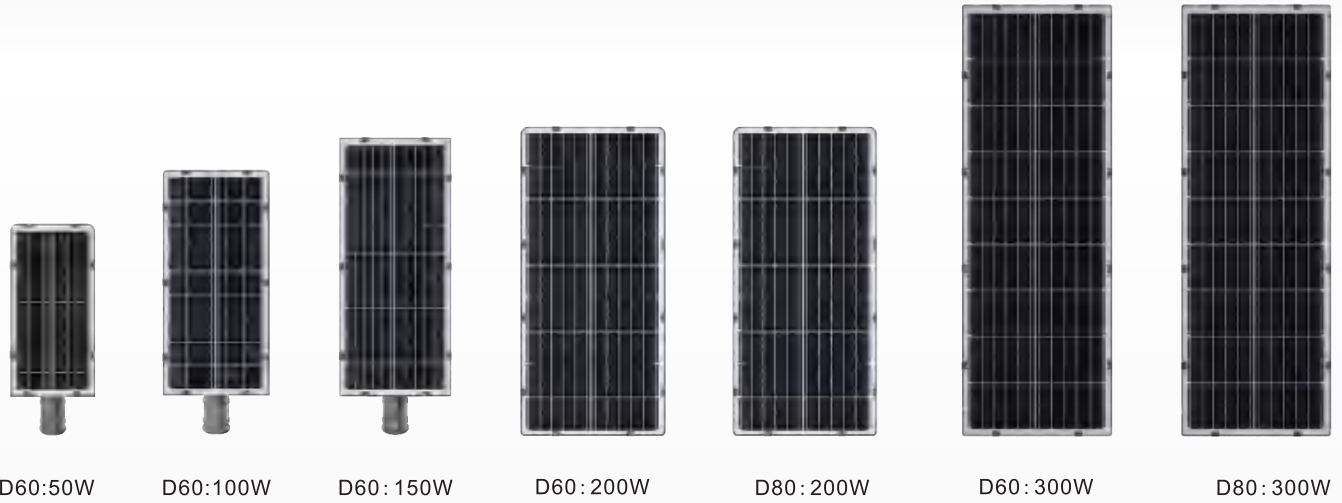
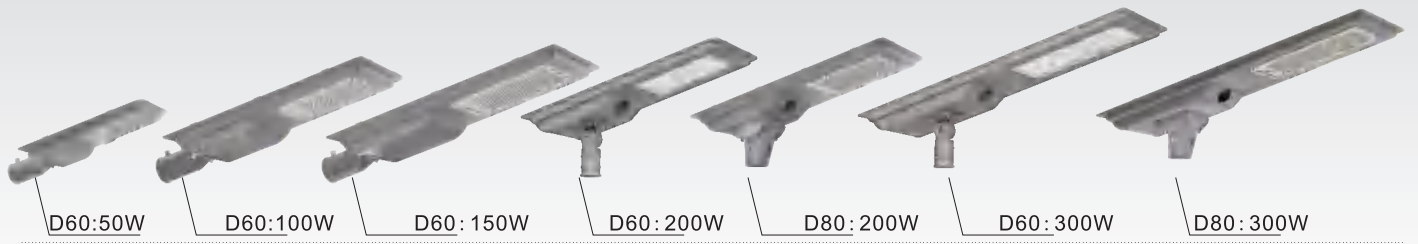

DIAGRAMS

Unit:mm

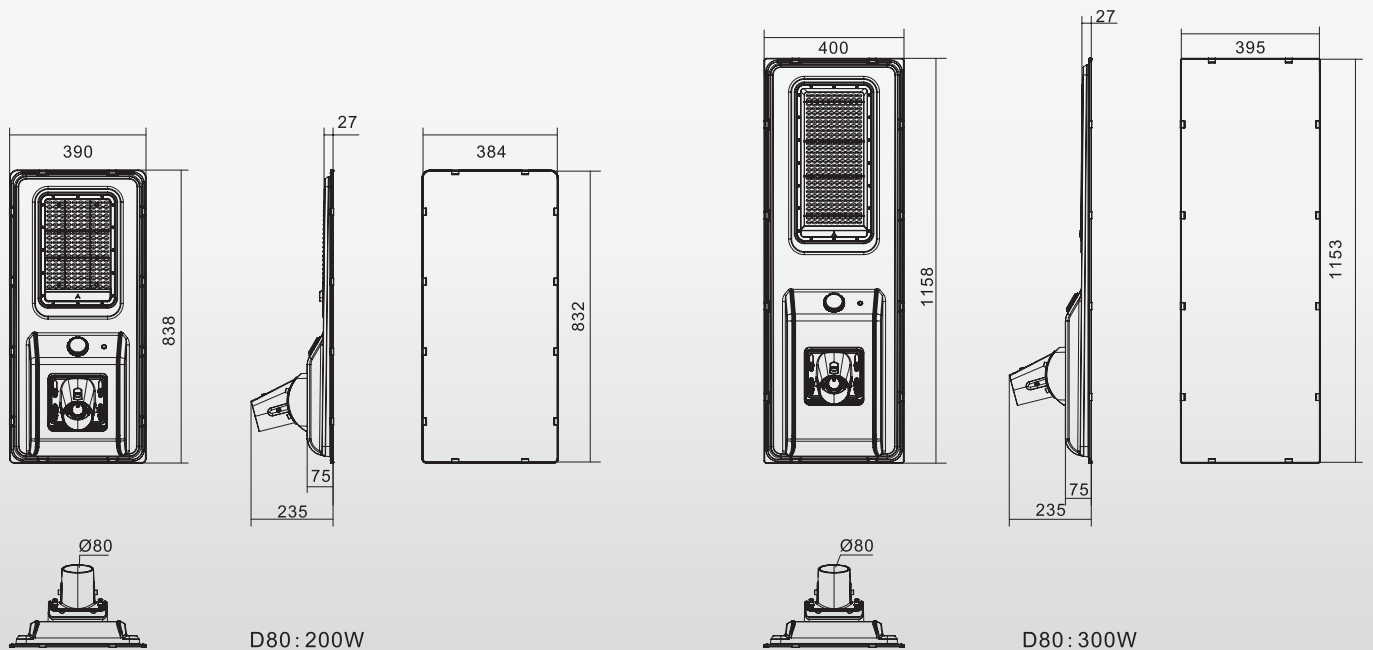
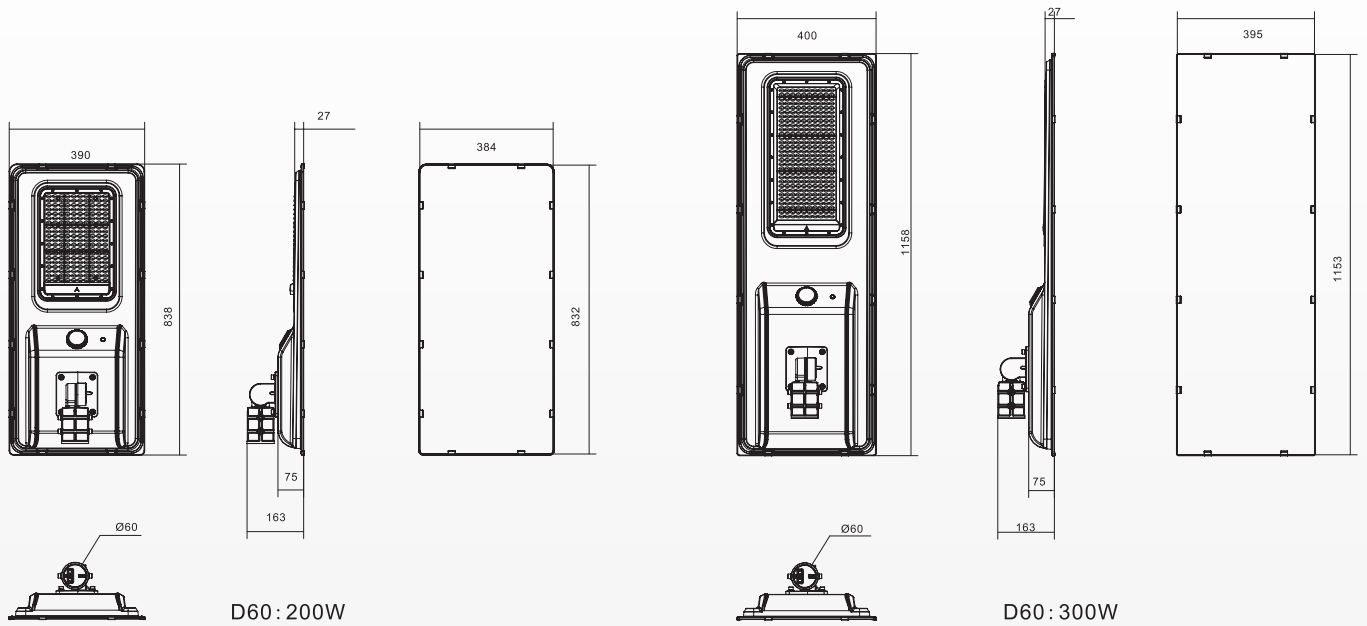
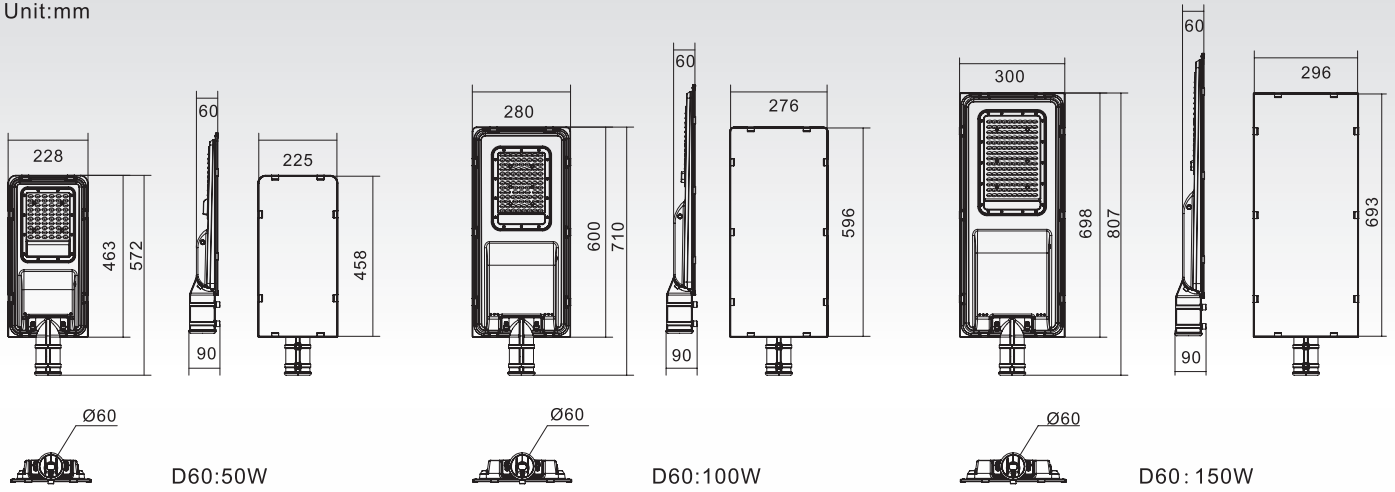

MAIN PARAMETERS

| Power | Light Source(QTY) | Body Size(mm) | Pole Diameter(mm) |
|--------------|-------------------|----------------|-------------------|
| D60:50W | 5050:60PCS | 572*228*90mm | Ø60mm |
| D60:100W | 5050:100PCS | 710*280*90mm | Ø60mm |
| D60:150W | 5050:150PCS | 807*300*90mm | Ø60mm |
| D60/D80:200W | 5050:200PCS | 838*390*235mm | Ø60/Ø80mm |
| D60/D80:300W | 5050:300PCS | 1158*400*235mm | Ø60/Ø80mm |

PACKING

| Power | QTY/CTN(PCS) | CTN Size(cm) | QTY/20GP(PCS) | QTY/40GP(PCS) | QTY/40HQ(PCS) |
|--------------|--------------|--------------|---------------|---------------|---------------|
| D60:50W | | | | | |
| D60:100W | | | | | |
| D60:150W | | | | | |
| D60/D80:200W | | | | | |
| D60/D80:300W | | | | | |

INSTALLATION LOCATIONS



INSTALLATION HEIGHT

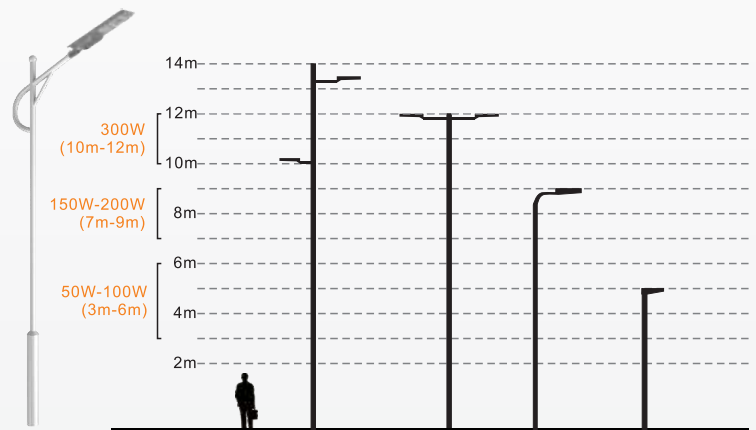

FEATURES

1. Adjustable arm/fixed adapter optional.
2. High lumen 5050 SMD LED light source.
3. Zinc coated iron body design, rust-free and efficient in heat dissipation.
4. The lamp body has a special drainage hole design.
5. Suitable for road lighting in urban areas such as urban streets and main traffic roads.

CAUTIONS:

1. Installation must be done by professional electricians.
2. Do NOT dismantle the product. It may be dangerous.
3. Do NOT stare at the light with naked eyes. It is harmful to eyes.
4. Solar panel should be installed towards sun. And it must NOT be sheltered by trees or any other covers.